

ORBCOMM Installer

Onboard ORBCOMM devices faster, cheaper and with less risk of human error

The ORBCOMM Installer mobile app makes deploying ORBCOMM devices and pairing them with assets easier than ever, enhancing productivity, improving efficiency, cutting installation time and costs, reducing support calls and minimizing errors.

Installers can use the app to:

- see step-by step instructions on how to activate devices
- scan and pair device and container IDs
- receive alerts for invalid pairings
- view available jobs organized by customer and assets
- see pre-loaded local weather, temperature conditions and nearby customer yard and depot locations
- accept new work
- monitor device health by checking battery status, location and reporting dates and times
- compare individual performance against scoreboards

The ORBCOMM Installer app features training tutorials and quizzes with certification to verify understanding before installers can access jobs. All installer actions are logged, with distinct access levels for supervisors and users to enhance security.

Quicker device installs

Reduced support calls

In-app training and certification

Enhanced security with access control

Fully configurable

Installation photos can be uploaded to the ORBCOMM Installer app at any time for recordkeeping and to provide proof of installation. Plus, there is a leadership program with scoreboards to recognize and incentivize installers to get more installs done quickly and accurately.

The ORBCOMM Installer app features an emergency SOS button, chat support and customizable background colors, themes, language preferences, date and time formats and notifications.

Supported devices: CT 1010, CT 3600, GT 1230

Software requirements: iOS 15.5 and above, Android 10 (Level 29 and above)

Versions: iOS, Android

Availability: Apple App Store, Google Play Store

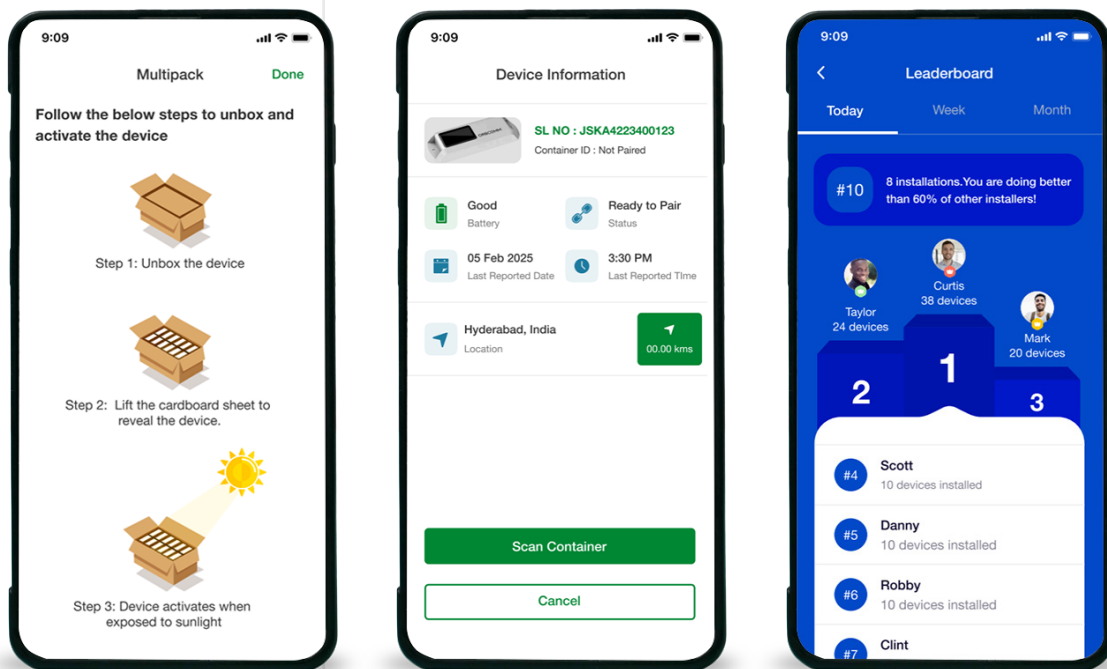

Although we strive to ensure accuracy in all of our published specifications, actual field performance can vary depending on a variety of environmental, installation and usage factors, as well as third-party factors such as cellular providers. The specifications listed are approximations, and do not constitute binding statements or modify the terms and conditions of purchase or lease including, but not limited to, product operational limitations and warranties. All specifications are subject to change without notice. Please check www.orbcomm.com to ensure you have the latest version of these specifications.

For more information on our solutions or to book a demo, email us: info@ORBCOMM.com

Visit our website www.ORBCOMM.com

ORBCOMM is a global leader in industrial IoT, delivering visibility, intelligence and efficiency to the world's most critical operations. With 30 years of innovation and more than 2.4 million connected devices, we transform data into actionable insights, driving greater efficiency, safety, resilience and sustainability. Serving customers that include the world's largest shipping lines, over-the-road trucking fleets, cold-chain transportation fleets and a global network of IoT solution provider partners, ORBCOMM is where IoT powers asset intelligence.